

Moralt Door Kit

A PASSIVE HOUSE COMPLIANT DOOR KIT WITH ACCESSORIES.

CE-MARKED – EN14351-1:2006, EXTERNAL WINDOWS & DOORS

Non-bow
10 years
guarantee



Passivhaus – Passive House

A Passive House is a building in which a comfortable interior climate can be maintained without active heating and cooling systems. The house heats and cools itself, hence the term “passive”.

Typically a Passive House operates on the following basis:

- passive external heat gains from the sun as well as internal gains from appliances and the building’s occupants
- significantly notable levels of airtightness and insulation with minimal thermal bridges
- a high level of internal air quality provided by a mechanical ventilation system that recovers heat efficiently

The inclusion of high level thermally insulated windows and doors is critical in achieving these criteria. This Passive House Institute certified component is your opportunity to participate in this exciting new concept.

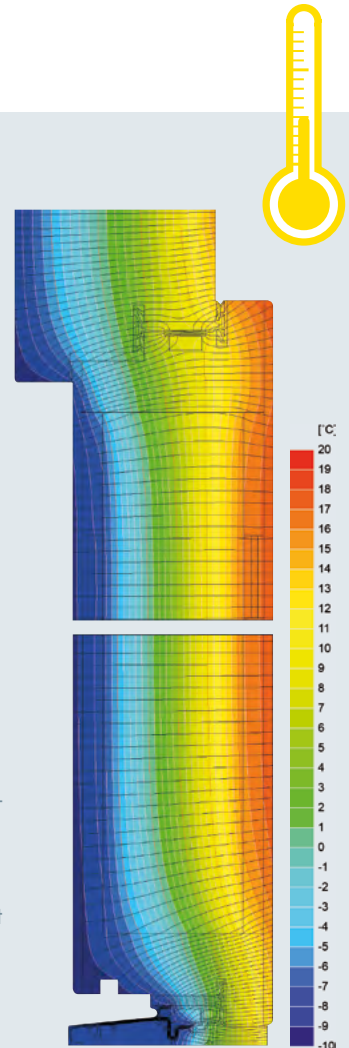

Passage of temperature through the door element

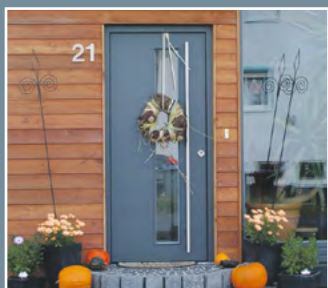

- The Moralt Passive House door blank is a certified Passive House component from the Passive House Institute in Darmstadt, Germany.
- The Passive House door blank has a U Value of 0,54 W/m²K; the Passive House door, as supplied in kit form has a U Value of ≤ 0,80W/m²K (with and without glazing).
- The Moralt Passive House door blank is CE certified (EN14351-1:2006 External Doors and Windows) and attains the best results in all mandatory aspects of this standard. Eg, wind-load resistance EN 12210, security classification RC2 (door blank resistance classification 3) EN 1627, airtightness classification EN 12207.

DOOR BLANK



MORALT FERRO PASSIV HOUSE DOOR KIT	
Maximum manufacturing sizes	
Frame size	upto 1.310 x 2.650 mm
Blank Size	upto 1.230 x 2.600 mm
Door blank thickness 98 mm	
Facings 5 mm thick	
MDF*	exterior grade
Meranti	5 ply long grain Finition veneer
Okoume*	5 ply long grain sliced veneer
Oak	5 ply long grain sliced veneer
Pine	5 ply long grain Finition veneer
Stiles & Rails and door frames engineered solid timber	
Meranti*	when Okoume or Meranti facings
Oak*	when Oak facings
Pine*	when Pine or MDF facings

* available with FSC certification

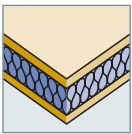
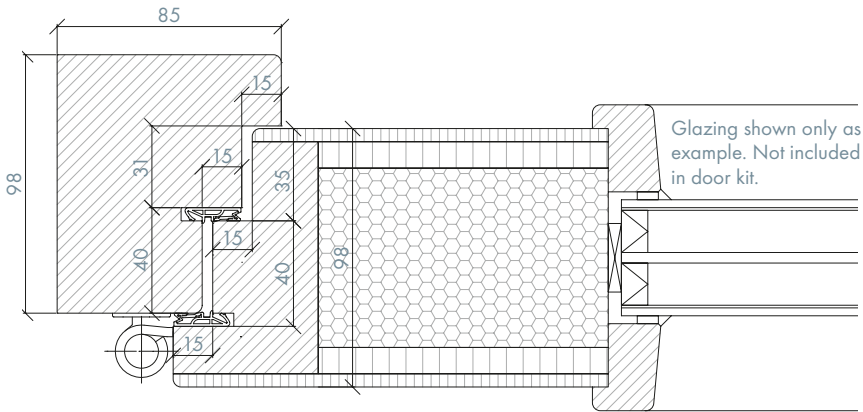

Solid PU thermal core

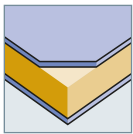

Exterior grade MDF faces

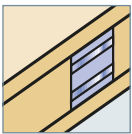

Flat steel stabilizer

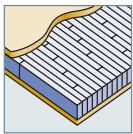

Laminated core



Robust construction

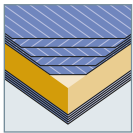

Decorative 5-ply faces on request

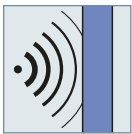

Acoustic insulation dB 42 on request



Fire-rating FD30/FD60 on request

WHAT IS INCLUDED IN THE DOOR KIT?

MORALT STANDARD COMPONENT PACKAGE	
Door	Moralt FERRO Passiv
Frame	3 Pieces
Hinges	Simonswerk BAKA 3D
Lock	3 Point Lock
Threshold	GU Systemhaustürschwelle
Seal	Deventer DS 155a anthrazit
Packaging	Boxed with foam corners

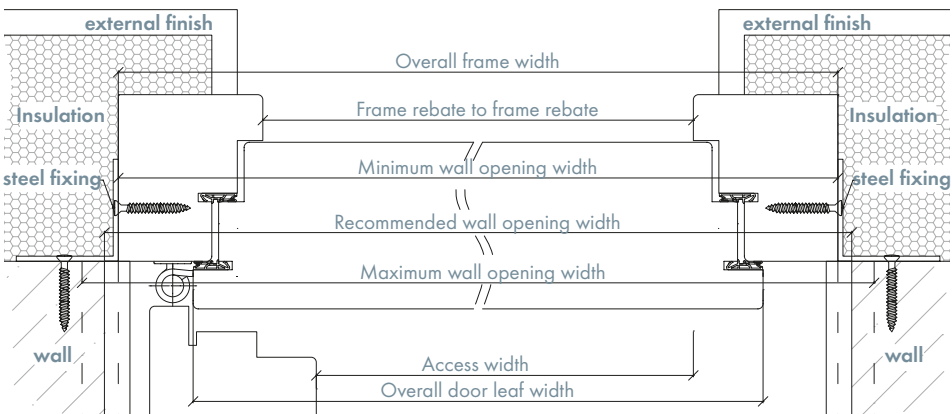

Any Questions? Info-Hotline: +49 8026 92538-11 www.moralt-ag.com

Moralt AG, Obere Tiefenbachstraße 1, 83734 Hausham, Phone: +49 8026 92538-0, Fax: +49 8026 92538-40, E-Mail: info@moralt-ag.de